

MODEL  
MAKER

STOP PRESS MARCH 2014: This problem has now been solved by Christian Sheppard. Despite the two top horizontal windscreen struts looking like they follow the curvature of the rain gutter, they are in fact straight pieces of timber.

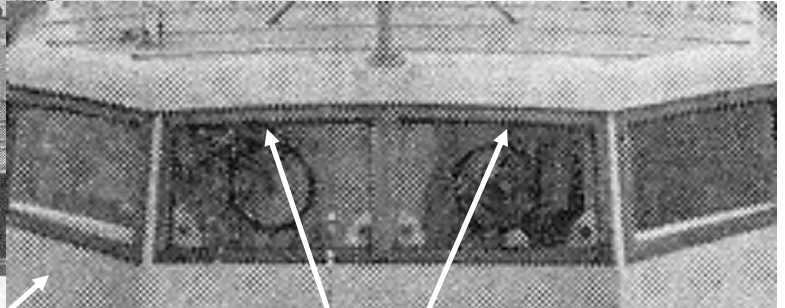
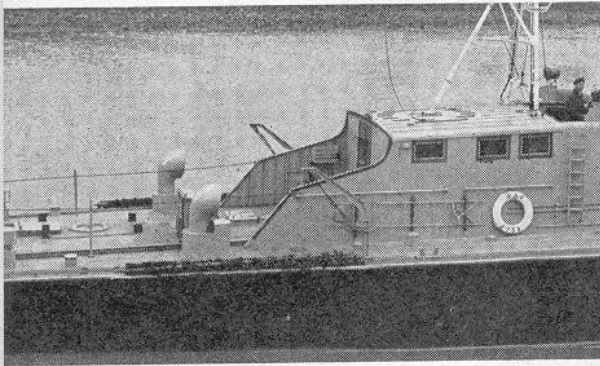

Q: Are these two timber struts curved or straight?

This is the clearest image I have been able to source - but it's still inconclusive. Though the struts do look curved in this particular photo, the curvature of the roof and gutter may be creating an optical illusion.

Personally speaking, I can't imagine the builders going to such lengths as to build labour-intensive curved parts for a boat of this nature - but I would be happy to be proven wrong.



Here the upper two struts appear to be straight.



The shape of the two upper struts here is inconclusive but they do appear to be straight.

Q: Is the engine cabin the same height as the towing cabin?

Varying drawings and models I've seen on the Net are inconsistent. The drawings below as you will note are inconsistent. They show the towing cabin height to be the same but the engine cabins are different heights.

Images of the real boats or model boats that I've viewed are inconclusive. It's very hard to find clear, directly side-on views at close range of this section of the boat.

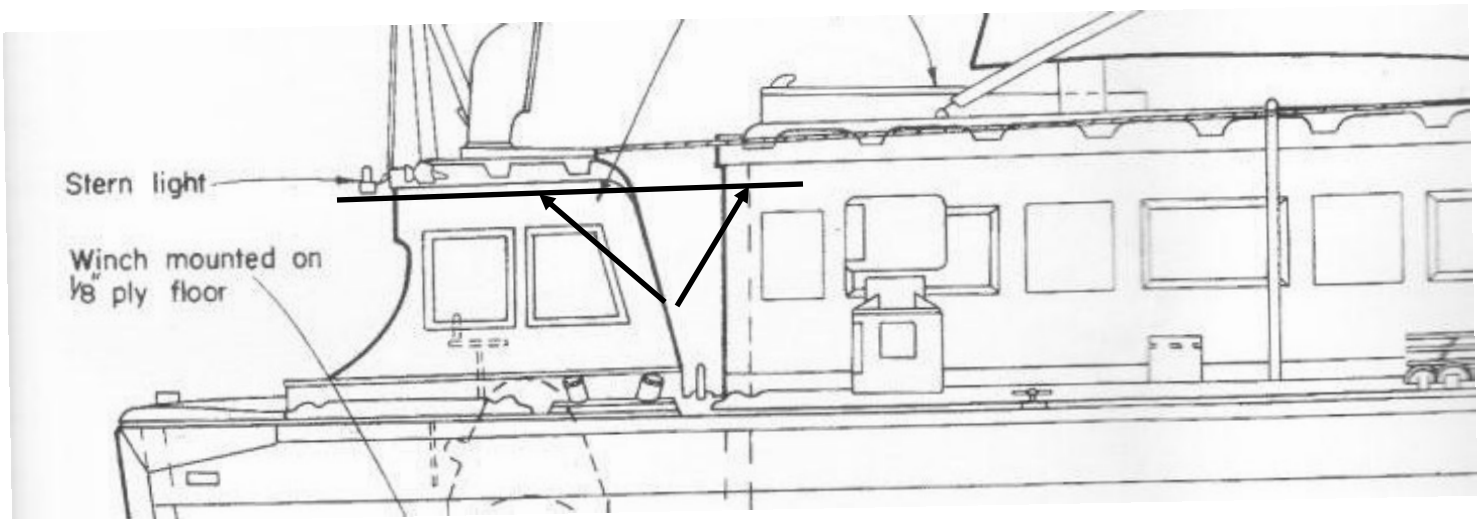

Vic Smeed Plan.



This plan was found on the Net. The author is unknown, though it appears to have been directly copied off Vic Smeed's drawing with subtle differences, including different hand writing.



Q: Does anyone have photos and/or details of the inside of the bridge?

The Dean's Marine model below is the only one I've come across on the Net which has the bridge comprehensively detailed, though I'm yet to work out how one gets up onto the bridge from the side sliding door.

Q: Are there steps or a ladder?

Q: Is there a fold down partition to close off the entry once you are inside the bridge?

Q: How do the instruments and wheel look?

Q: Are there seats - perhaps fold down ones?



Does this door open outwards?

Primarily using this image, I was able to establish the height of the bridge floor. It's approximately 3-1/4' above the deck. Scaled down, this works out at 1-5/8" on the model. I wonder how close I am? My calculations were based on the average height of the crew. The height of the crew member standing next to the cabin door, assuming he is about 5'8"-6' tall, also confirms the height of the cabin according to Vic Smeed's plan.

STOP PRESS MARCH 2014: This question has been answered. See the red text below.

One of the hardest sections to verify is the vertical support struts in the rear of the main cabin as shown. I could only find two images which appear to show 10 struts on either side as indicated with black lines. How many do you reckon?

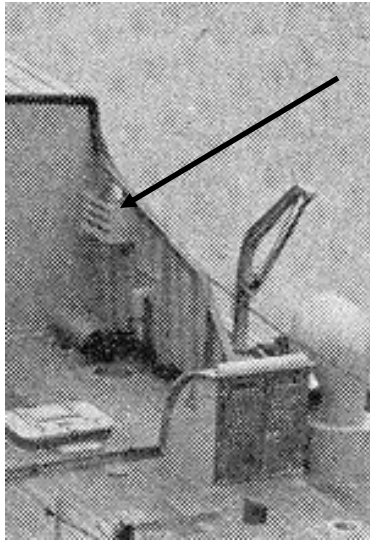

What are these?

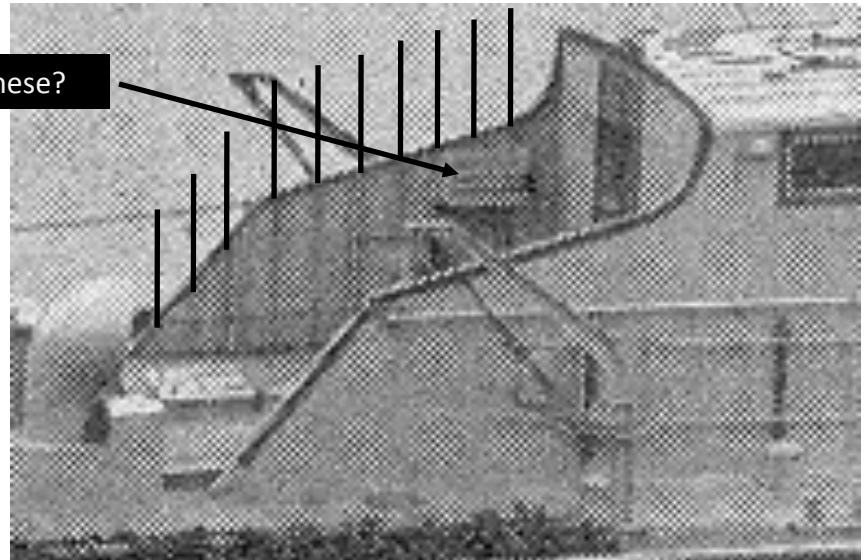

The Dean's Marine model below (shown on another page) is the only one I have come across which would indicate that the builder has got the configuration of the struts correct, though I can't verify the number of struts as some are hidden from view.



STOP PRESS MARCH 2014: Christian Sheppard has answered this. There are in fact 9 vertical support struts as clearly shown below on the once family owned 2753 aka 'Flywood'. I have yet to see any model which has the correct number of struts. Then again, I am learning as I go that there were several companies which built these boats so who's to say that each company didn't make subtle changes to the original design.



STOP PRESS MARCH 2014: This page was sent to Christian Sheppard for assessment. I am still seeking answers to the questions below if anyone else would like to get in on the act.

Does this part of the skirting overlap one or both sides of each side wall and is it the same width all around, including the roof?

What's this?



I'm guessing the cross section of the left-hand side wall

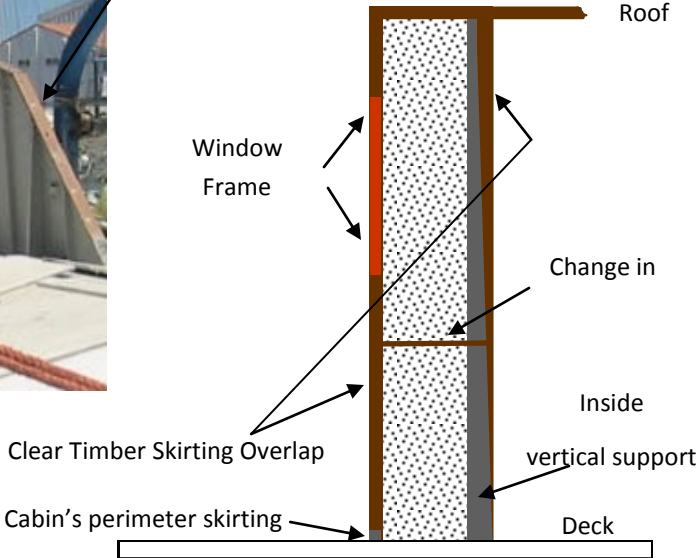

At the rear of the main cabin all the models I've viewed show the deck to be at the same level as everywhere else. On the real boats you can't tell this at a distance. However, Flywood's deck shows what appears to be a raised cover taking up the whole area and beyond of the two side walls. Is this the same for all boats?

STOP PRESS MARCH 2014: The above mystery of the raised cover has been solved. According to Christian Sheppard, this cover was not part of the original design, though I have seen at least one model which has this feature.



The stern shot of the 2754 sinking and another stern shot I've seen of the same boat shows the four numbers on the stern to be immensely different in size in both photos. I guess these boats have had several upgrades and/or make-overs over their time in service. Unfortunately, this only creates more headaches for the modelmaker, i.e. which boat to model off?

Q: Can anyone elaborate on these terms - especially the wording in brackets? i.e. were there two different manufacturers of the boat?

RAF No.	YARD No.	ON CHARGE	DISPOSAL
2753	2507	28/01/56	27/01/69 } (Converted to RTTL MkII (238MU Calshot)
2754	2508	29/02.56	30/01/62 } (Converted to RTTL MkII (Mount Batten)

I understood the Vosper RTTL 2754 I am rebuilding is a MkI.

Q: What did they do to make it a MkII and/or does this come under 'different manufacturers'?



Dean's Marine Version

